

ANNUAL REPORT

2024



Healing Hearts, Building Futures

Empowering South Kivu through Community-Led Solutions



www.csc-drc.org

csc.asbl@gmail.com

+243999488012



Message from the Founder

2024 has been a year of transformation, resilience, and collective action. Together, we have empowered over **3,724 women, children, and youth** in South Kivu, creating pathways to healing, education, and opportunity. Through **Play4Peace, environmental restoration, entrepreneurship, and trauma healing**, we have not only changed lives but also strengthened the foundation for a more just and inclusive future.

This year, we expanded our partnerships, welcomed incredible new team members, and reinforced our commitment to **collaborative and sustainable leadership**. I am honored to have earned my **Collective Leadership Specialist certification** from the **Collective Leadership Institute in Germany**, equipping us with advanced tools to drive impact through dialogue, stakeholder engagement, and shared responsibility. This achievement reaffirms that **true change happens when we come together, share knowledge, and take collective action**.

As we look ahead, our vision remains clear: to **scale our programs, expand opportunities, and create lasting impact** in communities affected by conflict and displacement. However, **we cannot do this alone**. We invite **donors, funders, sports clubs, enterprises, and organizations to collaborate with us**. Together, we can build a future where every child, woman, and youth has the chance to heal, grow, and thrive.

Thank you for believing in this mission, for standing with us, and for making transformation possible. **Your support fuels change. Your partnership shapes futures**. Let's keep working together to **Heal Hearts and Build Futures**.

In peace and solidarity,
Byolenganya Olo Bernoulli
Founder & Executive Director, CSC-Asbl



Healing Hearts, Building Futures



At the Community Support Center (CSC-Asbl), we believe that even the smallest contribution can spark significant changes in our communities.

Who We Are

1

Community Support Center (CSC-Asbl) is a grassroots non-profit dedicated to fostering social justice, human rights, and inclusivity. With a profound commitment to empowering women, children, and youth, we tirelessly work to build a more equitable and compassionate society.

In the conflict-affected Eastern Democratic Republic of Congo, we bring hope and resilience through trauma healing, education, sports for peace (P4PM), environmental management, and women's entrepreneurship. Guided by our motto, Healing Hearts, Building Futures, we transform lives, creating opportunities for vulnerable communities to thrive.



Vision

We promote the human rights of women and children through fellowship and empowerment. We bring joy and hope for a better future to survivors of conflict so that they can become productive members of society.



Mission

We provide vital support and assistance to women and children who have endured the horrors of war, ethnic conflict, and natural disasters. with the goal that they can regain meaningful participation in society.



Goal

Our overarching goal is to enhance the well-being of women, children, and youth in eastern DR Congo amidst conflict-affected and insecure environments.



Values

Dignity
Humanity
Solidarity

New Team Members and Advisors



This year, CSC-Asbl reached a significant milestone by welcoming a diverse team of professionals from DR Congo, the UK, Spain, France, and the USA. With expertise spanning mental health, emotional intelligence coaching, community development, entrepreneurship, environmental management, and ITC, this team embodies the spirit of collective leadership. Together, they envision innovative solutions to advance our mission of Healing Hearts and Building Futures. With representation across three continents, this achievement underscores our commitment to resilience, collaboration, and creating a transformative global impact.

Healing Hearts Building Futures

Grâce EPILI AOCI
Webmaster assistant

Grâce Epili Aoci, a graduated ICT Specialist, enhances CSC-Asbl's digital platforms, amplifying impact and connecting communities through innovative web development and technology solutions.

Contact us
csc.asbl@gmail.com
<https://www.csc-drc.org>

Healing Hearts Building Futures

Maria Oset Serra
Advisor

An international development expert with experience in Africa, Latin America, and Central America. Her expertise in community infrastructure, justice reform, and public policy helps guide CSC-Asbl's strategic growth.

Contact us
csc.asbl@gmail.com
<https://www.csc-drc.org>

Healing Hearts Building Futures

Nicola Charalambidou
Programs Director

Nicola will serve as Programs Director and Digital Engagement Specialist, ensuring impactful online communication and engagement strategies to amplify CSC-Asbl's initiatives and foster meaningful connections globally.

Contact us
csc.asbl@gmail.com
<https://www.csc-drc.org>

Healing Hearts Building Futures

Nick Atzeni
Advisor

Certified Emotional Intelligence Coach, enhances our P4PM program by empowering staff and youth with emotional resilience, leadership, and performance skills, fostering long-term healing.

Contact us
csc.asbl@gmail.com
<https://www.csc-drc.org>

Healing Hearts Building Futures

ALIYABO ASUKULU Ernest
Agronomist Engineer Assistant

Eneret Aliyabo, an Agronomy graduate from UNDT University in Uvira, supports CSC-Asbl as Agronomist Engineer Assistant, ensuring continuity in empowering communities through sustainable agriculture.

Contact us
csc.asbl@gmail.com
<https://www.csc-drc.org>

Healing Hearts Building Futures

Kelsey Borrows
P4PM Coaches Mentor

Certified Mental Performance Coach with a Master's in Sport Psychology, mentors CSC-Asbl's staff, coaches and children in the P4PM program, enhancing confidence, leadership, and mental resilience.

Contact us
csc.asbl@gmail.com
<https://www.csc-drc.org>

Executive Summary

3

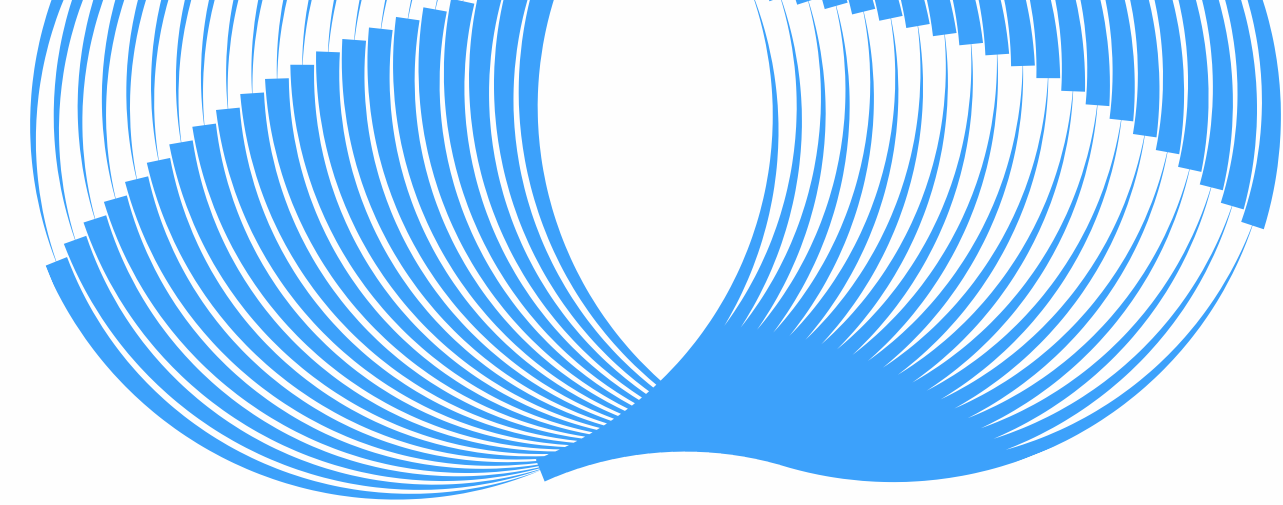

2024 was a year of growth, impact, and resilience for CSC-Asbl. Highlights include:

3,724 lives impacted through trauma healing, education, and empowerment programs.

EmpowerHer: Supported 50 women with leadership and entrepreneurship training.

Environmental Sustainability: Planted 100 trees and trained 50 women in sustainable farming practices.

Community support flourished during World Table Tennis Day, which brought together 957 participants, fostering inclusion and visibility in Kitundu Internal Displaced Persons Camp (IDP) in Uvira

Our annual Community Support Center Day drew over 1,300 participants, with coverage from local radio and television, amplifying our mission.

Strengthened partnerships with key stakeholders and joined impactful networks to amplify our reach.

Represented CSC-Asbl at the Equal Play Effect Convening in March 2024, where our team developed a gender action plan to enhance the inclusion of girls in sports.

P4PM (Play4Peace): 250 participants, 38% of whom were girls, breaking gender barriers.

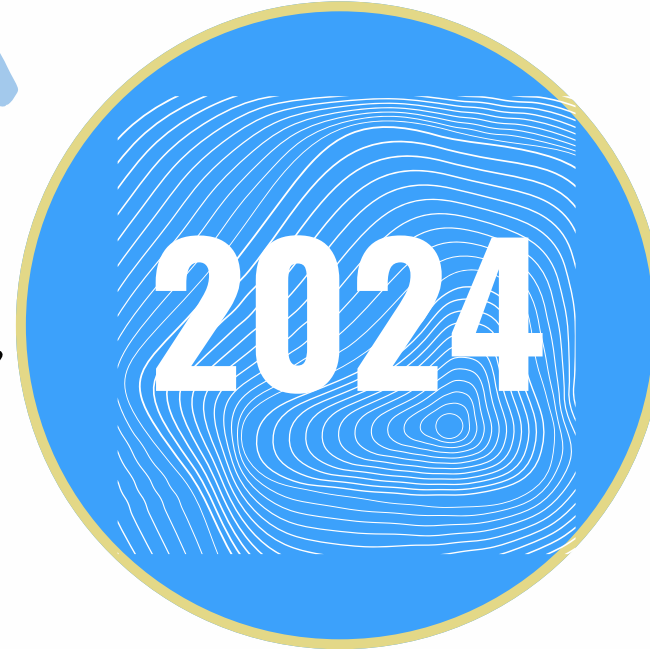

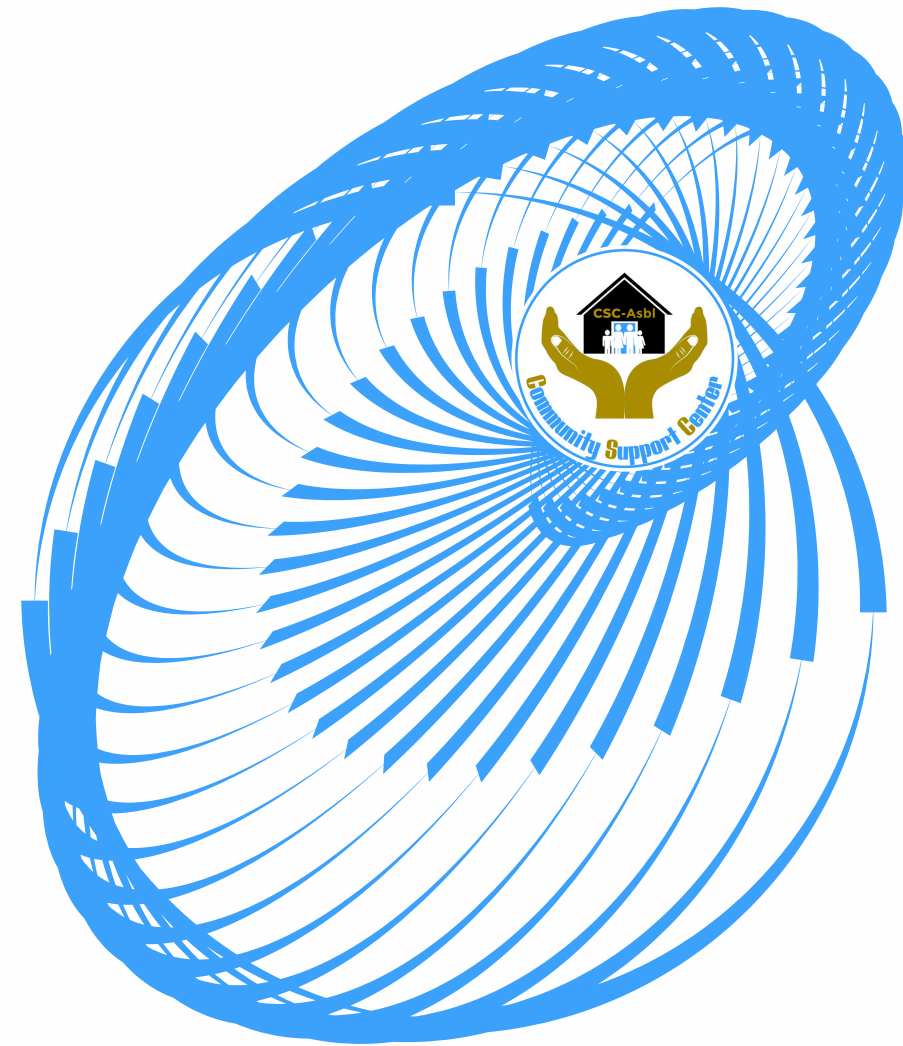

Key Achievements

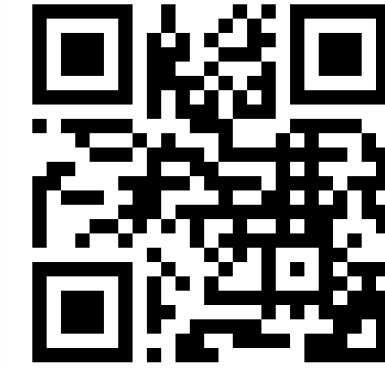



1. Trauma Healing & Peacebuilding

Play4Peace and Mental Health Support (P4PM) & Trauma Therapy













Key Achievements



1. Trauma Healing & Peacebuilding

- **Play4Peace and Mental Health Support (P4PM): Breaking Barriers Through Sports**

The Play4Peace program fosters mental health, social cohesion, and gender equality by engaging children and youth in inclusive sports and play-based activities. In 2024, 250 participants joined the program, with girls' participation increasing from 10% to an inspiring 38%. This milestone is a testament to our vision of breaking entrenched gender stereotypes and creating a future where every child has a voice on and off the field.

- **Trauma Therapy: Healing Hearts, Restoring Hope**

Through trauma therapy, CSC-Asbl provides safe spaces for women and children to process conflict-induced trauma. In 2024, countless lives were transformed as participants reported significant emotional resilience and renewed hope for the future. This work is at the heart of our mission to empower survivors to rebuild their lives and communities.

- **Our Vision: A Call to Collaboration**

We envision a world where every child, woman, and family can heal, grow, and thrive. Join us in expanding these programs to reach more vulnerable individuals in South Kivu. Together, we can build a future defined by resilience, inclusion, and opportunity. Partner with us today to make this vision a reality.



<https://www.csc-drc.org/get-involved/>





2. Mitigating Global Warming through Environmental Management

Seed the Future , PAFA Projects







GOD U WASTE

the Future Sh



Key Achievements

2. Mitigating Global Warming through Environmental Management

- **Seed the Future & PAFA: Planting Hope, Growing Resilience**

Through the Seed the Future and PAFA projects, CSC-Asbl empowers women in Uvira to embrace sustainable agriculture and environmental restoration. In 2024, we supported 50 women in Kitundu Camp, guiding them to adopt resilient farming practices. Additionally, 47 women farmers in Kawizi received ongoing agricultural advice. As part of the Seed the Future pilot project, supported by Wood U Waste, 100 fruit trees were planted, creating microclimates, reducing hunger, and fostering sustainable development.

- **Our Vision: Expanding Impact**

This project showcases how local efforts can spark global change. We aim to scale Seed the Future across the province and eventually the nation, inspiring communities to build a more sustainable and resilient world. Join us in expanding this transformative initiative and creating lasting environmental and social impact.

<https://www.csc-drc.org/get-involved/>





3. Supporting Youth through Education

Empower(EPH) & Education Support







Key Achievements

6

3. Supporting Youth through Education

- **EmpowerHer (EPH): Building Leaders and Entrepreneurs**

This year, 50 young girls from Kitundu International Displaced Persons Camp participated in EmpowerHer workshops. They received training in leadership, entrepreneurship, and life skills. Testimonials revealed increased self-confidence and a renewed sense of opportunity, enabling these girls to envision brighter futures.

- **Education Support: Enabling Dreams**

We provided 60 children from Kitundu Camp with school kits and funded 20 scholarships for displaced children in Itombwe, in partnership with local schools. Despite aiming to support over 250 children annually, financial constraints remain a challenge. These efforts were made possible through the generous support of Quakers in France and the USA.

- **Our Vision: Partnering for Education**

Education is the cornerstone of opportunity. To meet our goal of supporting 250 vulnerable children each year, we welcome sponsors and partners to join us in empowering the next generation to thrive. Together, we can ensure no child is left behind.



<https://www.csc-drc.org/get-involved/>



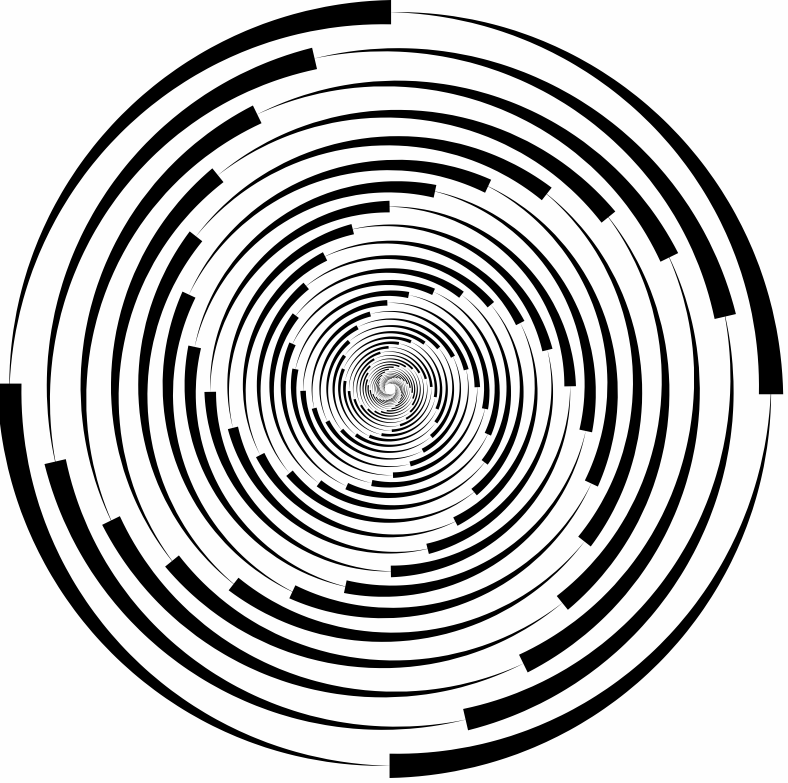

4. Community Engagement

World Table Tennis Day & Community Support Center Day









GR507-B
BK#08 W

DUMDASS
덤 다스
سادمروود
دام
DUMDASS

89







Healing Hearts Building Futures

Healing Hearts Building Futures

Healing Hearts Building Futures

Healing Hearts Building Futures

Healing Hearts Building Futures

Healing Hearts Building Futures

Healing Hearts Building Futures

Healing Hearts Building Futures

Emirates
FLY BETTER

WLO
ALL





Healing Hearts Building

Healing Hearts Building

Building

ITF BUNTING

adidas

adidas

adidas

adidas

adidas





<https://www.csc-drc.org/get-involved/>



Key Achievements



4. Community Engagement

- **World Table Tennis Day**

On April 23rd, CSC-Asbl hosted World Table Tennis Day in Kitundu IDP Camp, Uvira, with 957 participants celebrating diversity and inclusion. The event showcased the power of sports to foster unity and well-being, with local media amplifying its impact. We aim to expand table tennis initiatives in displaced camps, deepening our partnership with ITTF.

- **Community Support Center Day**

Community Support Center Day, CSC-Asbl's annual flagship event, embodies hope, resilience, and unity for vulnerable children worldwide. Dedicated to the most disadvantaged, this celebration reflects our founder Byolenganya Olo's enduring commitment, rooted in his own childhood struggles, to transforming lives through compassion and action.

This year, over 1,300 participants exceeding our initial goal of 1,000 came together at Kitundu IDP Camp in Uvira. The day was filled with inclusive sports, trauma-informed activities, community meals, and awareness-raising discussions with local leaders and media, fostering emotional healing and joy.

Looking ahead, we aim to celebrate with even larger groups of children in other IDP camps and villages across South Kivu and beyond. Your generosity fuels this mission, bringing light to children's lives and hope to families. Thank you for making this possible from Olo and the entire CSC-Asbl team. Together, we can keep building brighter futures.

- **Call to Action**

We invite partners to join us in expanding these impactful initiatives, using sports and community engagement to build stronger, healthier communities.



Representation at Equal Play Effect Convening

Advancing Gender Equality Through Sports



COMMON GOAL

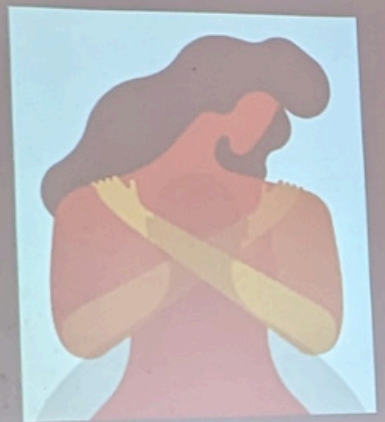

GENDER-BASED VIOLENCE

A closer look at this epidemic affecting society

Supported by 

GOALS

How to achieve those Goals

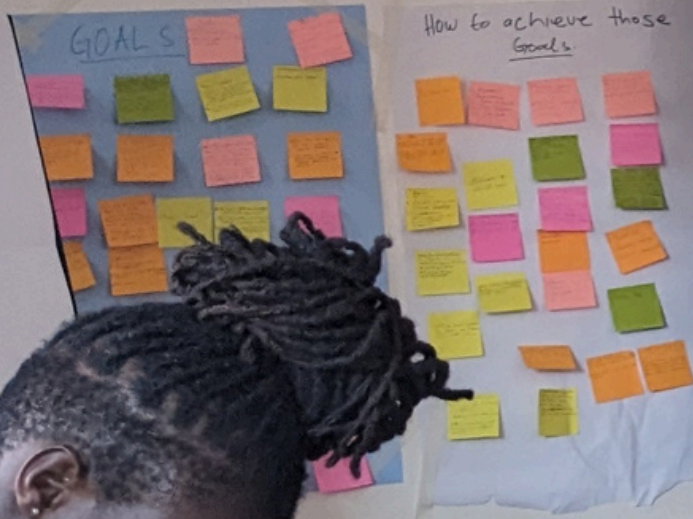

Equal Play Effect Africa



SOCCER WITHOUT BORDERS



CHANGE

JACKIE BLESS
Manager Institute for Women in the State of Africa - ASISA





NYAMIZI SYLVESTER
Peace for Conservation

FATHI KIBINGI
MyUp

SHITTE MUTHI
MyUp

REBEKKA KANYINGA
Peace for Conservation

Supporting the
Sustainable Development
Goals
SDG
MyUp

Equal Play Effect

Africa



WILES MUISE
Without Borders



Key Achievements



Representation at Equal Play Effect Convening

Advancing Gender Equality Through Sports

In 2024, CSC-Asbl embarked on a transformative journey toward gender equity, guided by the principles of the Equal Play Effect. Through a comprehensive gender self-assessment and action-planning process, we targeted impacts across three levels: on the pitch, on the sidelines, and within our organization.

Key Achievements

- Inclusive Sports: Increased girls' participation in Play4Peace clubs from 10% to 38%, fostering confidence and breaking gender barriers.
- Empowered Coaches: Trained four coaches in gender-sensitive practices, ensuring equity in sports programming.
- Organizational Change: Fully integrated a gender equality policy, embedding inclusivity into our core values.

Vision and Call to Action

We envision a future where sports empower all individuals, regardless of gender, to thrive. The strides we've made are just the beginning. With your support, we can continue creating inclusive spaces for participants, coaches, and communities. Together, let's build a world where equality is the standard, not the exception. Join us to transform lives through the power of sports.

<https://www.csc-drc.org/get-involved/>





Partnerships and Networks

Building Bridges, Expanding Impact

ACQNA



Global Network of Civil Society Organisations for Disaster Reduction



Key Achievements



• Partnerships and Networks: Building Bridges, Expanding Impact

In 2024, CSC-Asbl strengthened its partnerships and joined dynamic networks aligned with our mission to empower vulnerable communities. Collaborations with organizations like:

- Soccer Without Borders,
- Equal Play Effect Africa Network,
- Wood U Waste and The Free Website Guys enabled us to expand gender-inclusive sports, promote reforestation, and enhance community resilience.

We are also deeply grateful for the support of:

- Huntsville Quaker Meeting,
- Quakers En France,
- GNDR,
- KingCreto Experience,
- and many others who share our vision.

• Gratitude and Collaboration

We sincerely thank all our partners and supporters for believing in our mission. Your contributions have brought hope and tangible change to South Kivu.

• Vision and Call to Action

To expand our reach, we invite new partners, donors, and collaborators to join us. Together, we can scale these initiatives and create a lasting impact in South Kivu and beyond. Let's build a brighter future, one partnership at a time.

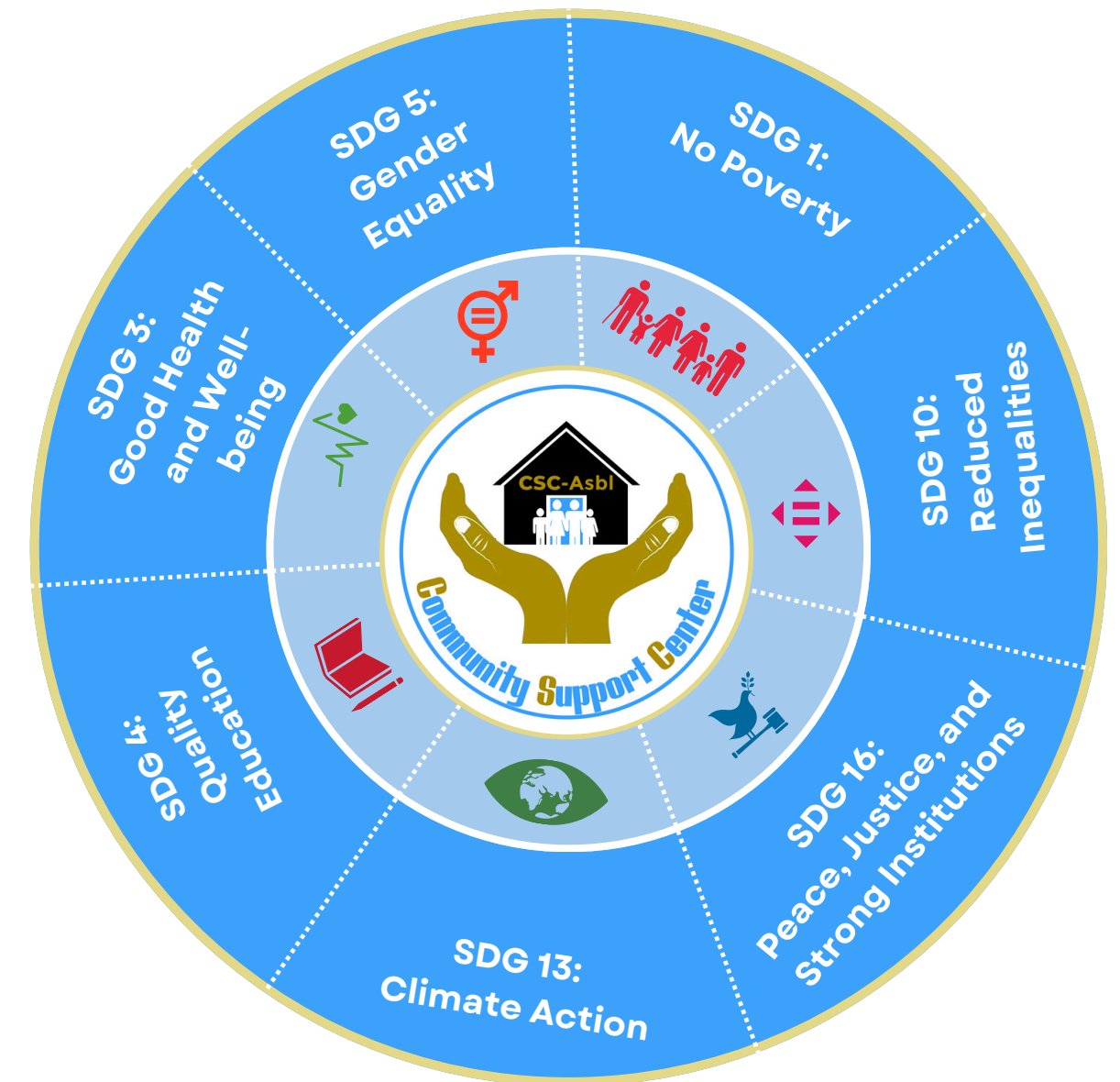

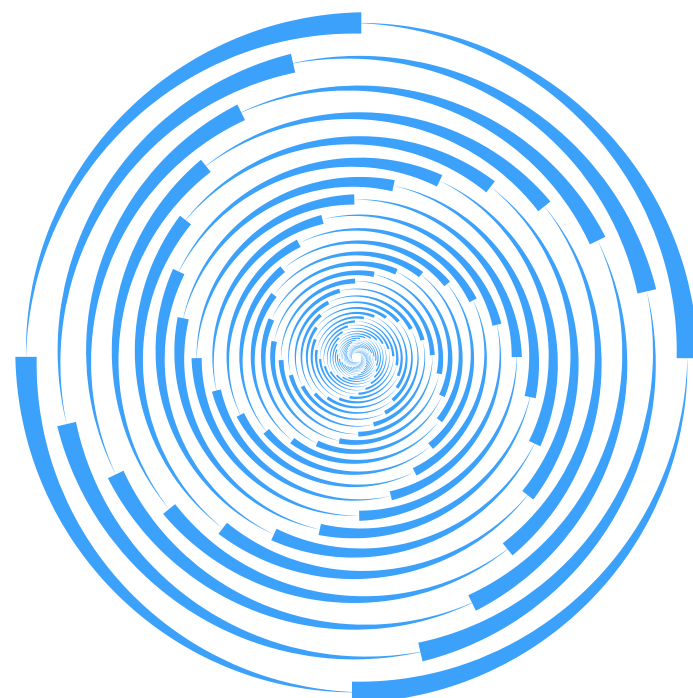

Success Stories

Transforming Lives Through
CSC-Asbl Initiatives



P4PM Girl Participant

Football gave me hope, friendships, and a space to heal from conflict trauma.



Lydia (Coach, P4PM)

P4PM's mixed-gender, local games foster inclusion, mental well-being, and social cohesion. Seeing children heal through play is inspiring.



Trauma Therapy Survivor

I found a safe space to heal, and now I help others find their strength.



Youth Education Support Beneficiary

Education gave me a chance to dream beyond survival, I now believe in my future



Parents of P4PM Players

Our child found joy, confidence, and discipline through Play4Peace.



PAFA Beneficiary (Kitundu Camp)

Farming skills mean food for my children and a future for my family.



EmpowerHer (EPH)

I learned leadership and entrepreneurship now, I believe in myself



Seed the Future Beneficiary

Planting trees isn't just about the environment; it's about hope for future generations



IDPs Representative

CSC-Asbl brings dignity and empowerment to displaced families in ways we never imagined.



Community Leader

Their work transforms lives. They don't just help; they inspire change.

Key Achievements



Financial Summary

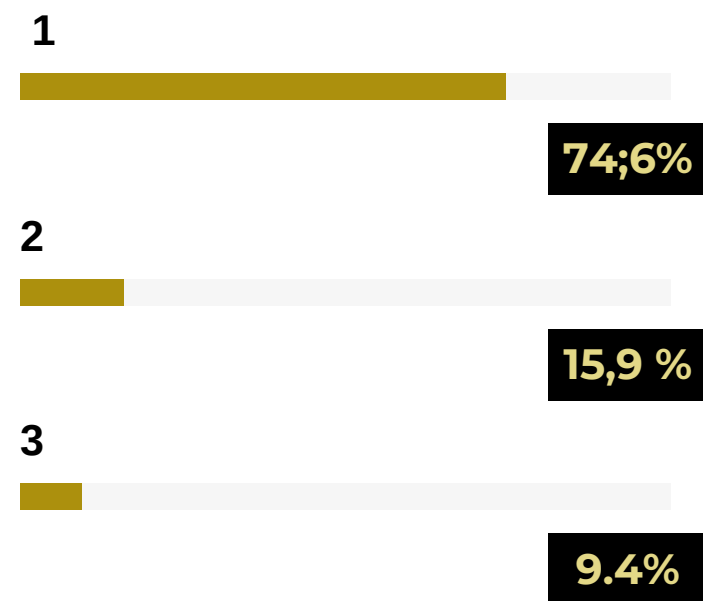

2024 Funding Overview:

- 74.6% (\$14,591): International and local donations.
- 15.9% (\$3,109): Grants supporting initiatives like ITTF and EPE.
- 9.4% (\$1,840): Program-specific grants for PAFA and EmpowerHer.

2024 Funding Utilization & Call for Partnership

At the Community Support Center (CSC-Asbl), we believe that even the smallest contribution can spark lasting change. In 2024, we effectively allocated our funding of **\$19,000**.

Only 4% covered administrative execution to keep operations running efficiently.

However, our biggest challenge remains financial sustainability. Despite our impact, our team works as volunteers due to limited funding. Without long-term donors and partners we struggle to expand life-changing programs for vulnerable women and children.

We seek committed partners and supporters to sustain our programs, empower our team and continue healing trauma, fostering resilience and transforming lives. Join us in building a future where every woman and child can thrive — your support makes the difference



CSC-Asbl SMART Goals for 2025–2026

- Seed the Future & PAFA: Expanding Environmental Initiatives
- Play4Peace & Mental Health Support (P4PM): Strengthening Gender Inclusion in Sports
- Education Support: Expanding Access to Learning
- Land & Infrastructure Development: Laying Foundations for the Future

- Celebrating Community Resilience & Fundraising
- Strengthening Monitoring & Evaluation (M&E) for Greater Impact
- Expanding Funding Sources & Partnerships

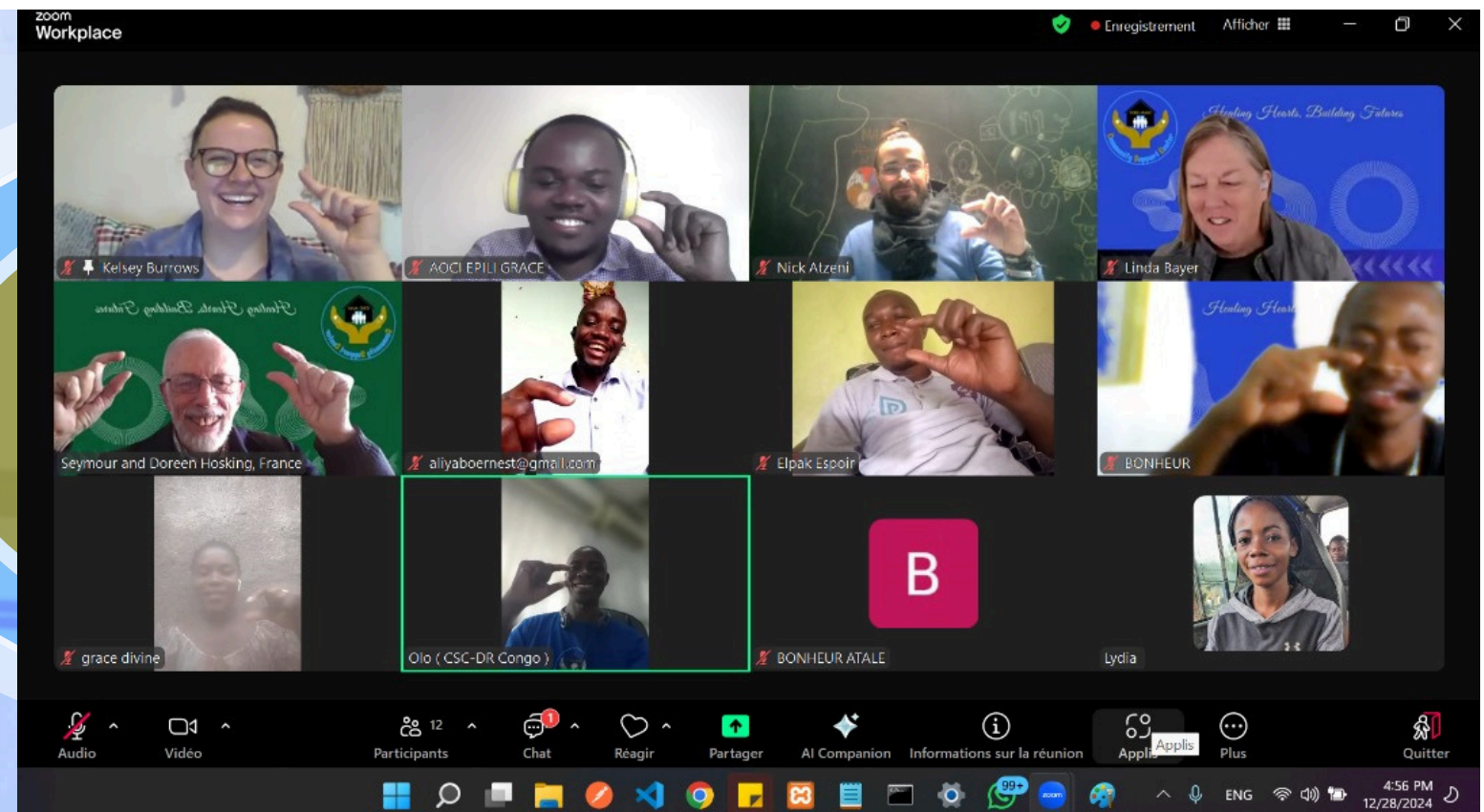
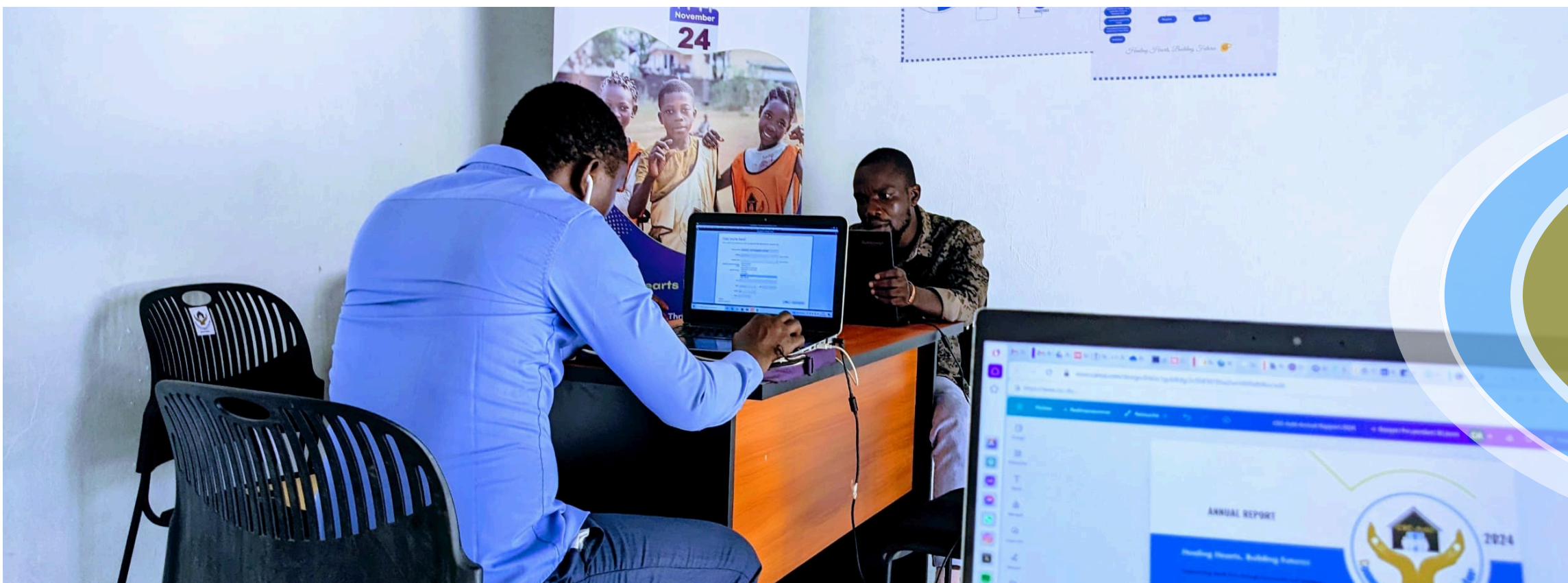



CSC-Asbl SMART Goals for 2025–2026

At Community Support Center (CSC-Asbl), we believe that every partnership can spark real change. Through collaboration, we can empower vulnerable communities and build a sustainable future. Below are our key goals, designed with clear impact and mutual benefits for our partners.

1. Seed the Future & PAFA: Expanding Environmental Initiatives

- The goal is to expand tree-planting initiatives to new areas and train 200 women in sustainable farming by the end of 2025.
- Why It Matters: Enhances climate resilience, food security and economic empowerment for displaced women.
- How Partners Benefit: Visibility in environmental advocacy, alignment with corporate sustainability goals and direct impact in climate action.

2. Play4Peace & Mental Health Support (P4PM): Strengthening Gender Inclusion in Sports

- Goal: Integrate 100 new participants into P4PM activities and ensure 50% female participation in sports and local games by the end of 2025.
- Why It Matters: Reduces gender barriers, fosters mental well-being and builds community resilience.
- How Partners Benefit: Recognition in gender equality advocacy, support for sports development and engagement in mental health initiatives.

3. Education Support: Expanding Access to Learning

- Goal: Provide 250 scholarships to displaced children and expand mentorship programs by the end of 2025.
- Why It Matters: Gives children affected by conflict access to education, breaking cycles of poverty.
- How Partners Benefit: Opportunity to sponsor individual students, contribute to long-term education impact and enhance corporate social responsibility (CSR).

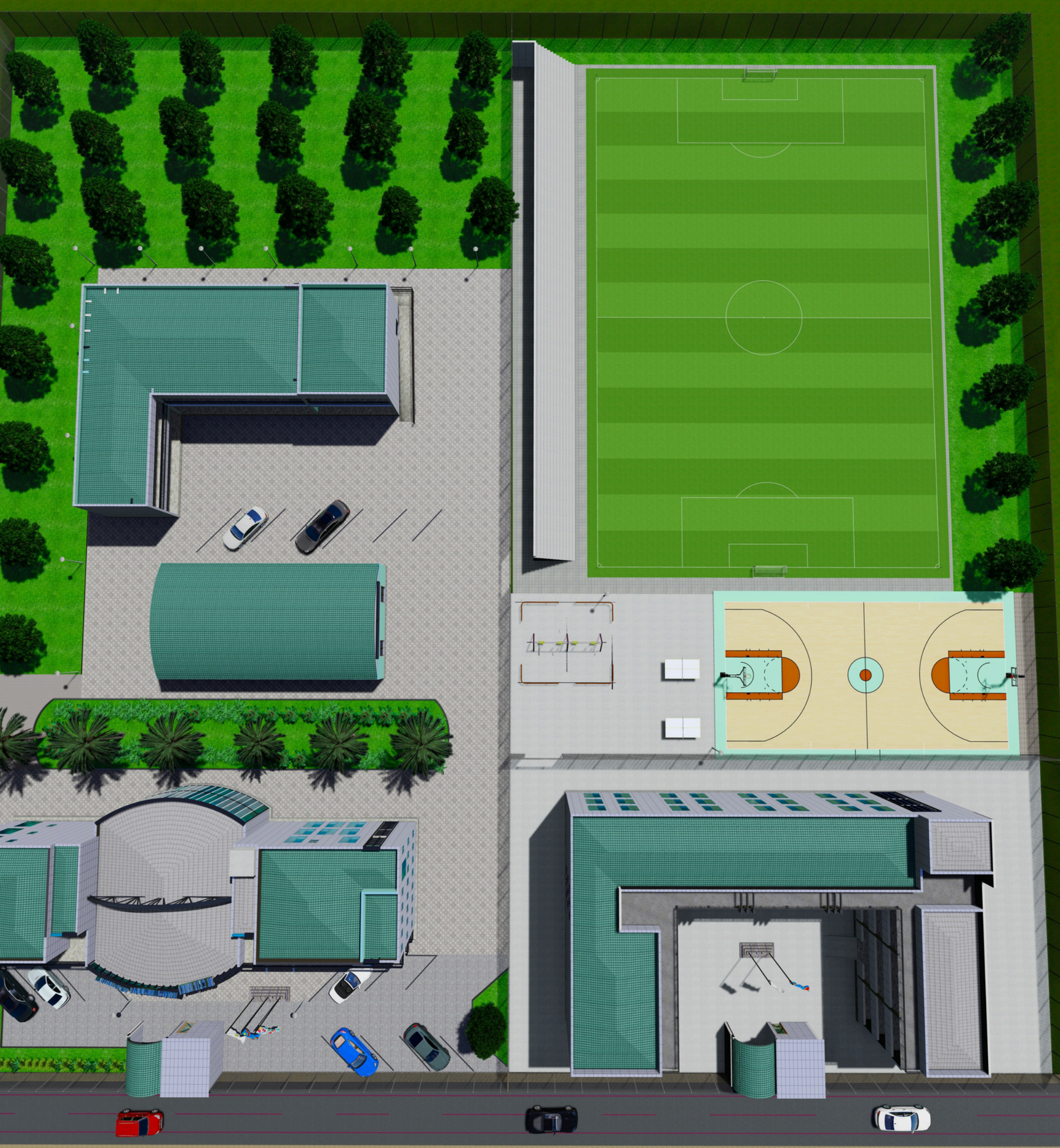

4. Land & Infrastructure Development: Laying the Foundations for the Future

- Goal: Begin fundraising to purchase land for a permanent CSC-Asbl center by the end of 2026.
- Why It Matters: Establishes a stable base for program sustainability and community support.
- How Partners Benefit: Long-term impact on community growth, branding opportunities and a legacy of transformative change.

5. Celebrating Community Resilience & Fundraising

- Goal: Celebrate achievements with over 1,500 community members and raise \$5,000 for the event.
- Why It Matters: Recognizes progress, fosters community unity and showcases the power of partnerships.
- How Partners Benefit: Brand sponsorship opportunities, visibility in community development and direct engagement with beneficiaries.

6. Strengthening Monitoring & Evaluation (M&E) for Greater Impact

- Goal: Develop robust tools to measure and assess program outcomes by the end of 2025.
- Why It Matters: Ensures accountability, improves program efficiency and demonstrates impact on donors.
- How Partners Benefit: Access to transparent impact reports, data-driven decision-making and stronger collaboration opportunities.

7. Expanding Funding Sources & Partnerships

- Goal: Partner with individual donors, foundations and organizations to secure sustainable funding for education, sports and environmental programs.
- Why It Matters: Provides long-term financial stability, allowing CSC-Asbl to grow its impact.
- How Partners Benefit: Alignment with social impact initiatives, personalized engagement in projects and brand recognition in humanitarian work.

Join Us in Creating Lasting Change!

By partnering with CSC-Asbl, you contribute to real solutions in education, sports, mental health and sustainability while also gaining visibility, impact-driven engagement and a shared commitment to a better world. Let's build hope, one action at a time!

Acknowledgment from the Executive Director & CSC-Asbl Team

As we close another year of resilience and transformation, we extend our deepest gratitude to every donor, partner, volunteer and supporter who has stood with us. Your belief in healing hearts and building futures has empowered thousands of displaced children, women and young people across South Kivu.

Despite challenges, we have grown stronger together, expanding our programs, increasing gender inclusion and fostering sustainable change. But our journey continues. The need is great, and with your partnership, we can do even more.

From the entire CSC-Asbl team, thank you for being part of this mission. Your support fuels hope, dignity and opportunity.

We envision a world where every child, woman and displaced person can heal, grow and thrive, where peace, inclusion and resilience replace trauma, exclusion and hardship. Together, we can turn this vision into reality. Let's keep building a future where no one is left behind.

In peace and solidarity

Byolenganya Olo & The CSC-Asbl Team



MEET OUR TEAM

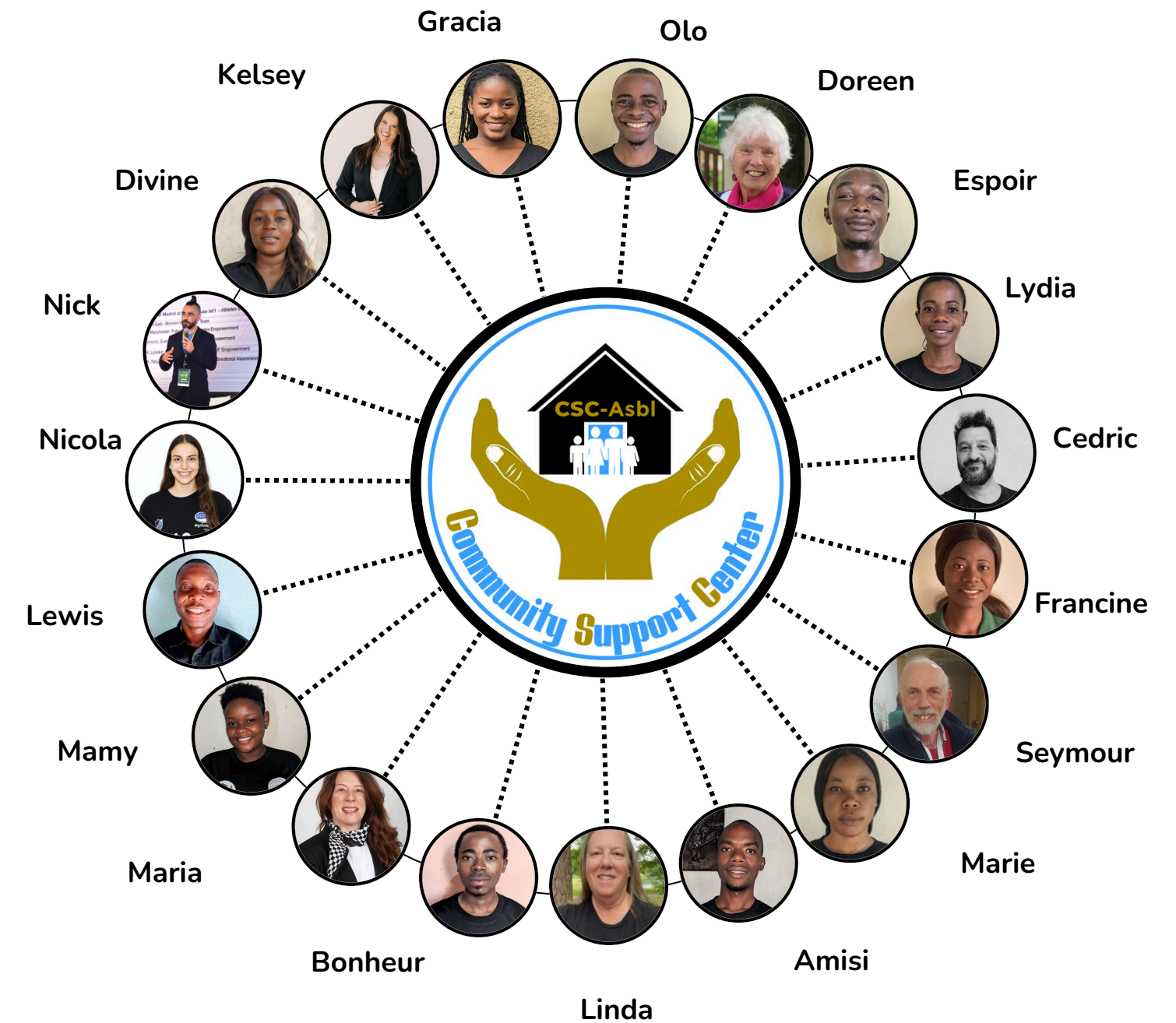

We are a team of empathetic and sympathetic people committed to one goal, improving the life conditions of the most vulnerable women, children, and youth in Eastern DR Congo.

We are Healing Hearts and Building Futures, by giving joy and hope so that the most vulnerable can become productive members of society.





Useful Links

- **Links**

CSC achievement: <https://youtu.be/b3TI6zyjy0U?si=hUphukRyjVWMPits>

CSC Day highlighting P4PM activities: <https://youtu.be/30ETZn6we94?si=6Ge6dS3Apj0tqbV6>

CSC Gender Equality Policy: https://www.csc-drc.org/wp-content/uploads/2024/07/CSC-Asbl-Gender-Equality-Policy_103237.pdf

CSC Child Safeguarding Policy: <https://www.csc-drc.org/wp-content/uploads/2024/06/CSC-Asbl-Child-Safeguarding-Policy.pdf>

A Grandmother's Dream: <https://agrandmothersdream.com/about-me/>

KingCreto Experience: <https://kingcretot.com/>

Collective Leadership Institut: <https://www.collectiveleadership.de>



Community Support Center